

CHNT

PV-HPC01x(x=-1) 规格说明书

PANEL RECEPTACLE INSTRUCTION



Zhejiang Chint Xinhui Photovoltaic Co., Ltd.

Add: No. 2 Xiabao Road, Yueqing Bay Port District, Yueqing City, Wenzhou City, Zhejiang Province, 325600 P. R. China.



外形尺寸 Overall Dimensions

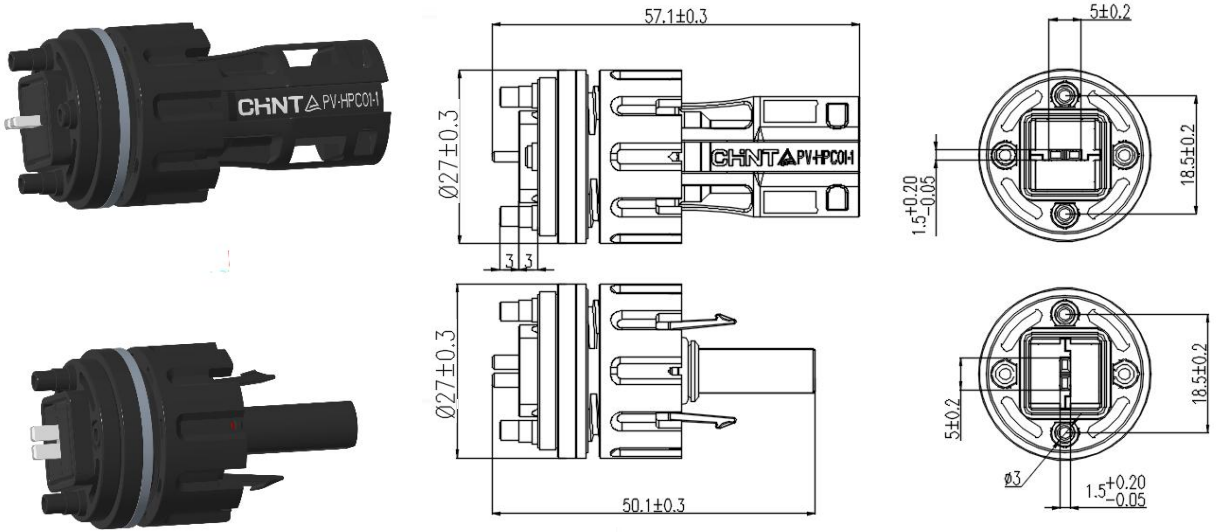

配合尺寸 Fit Dimensions

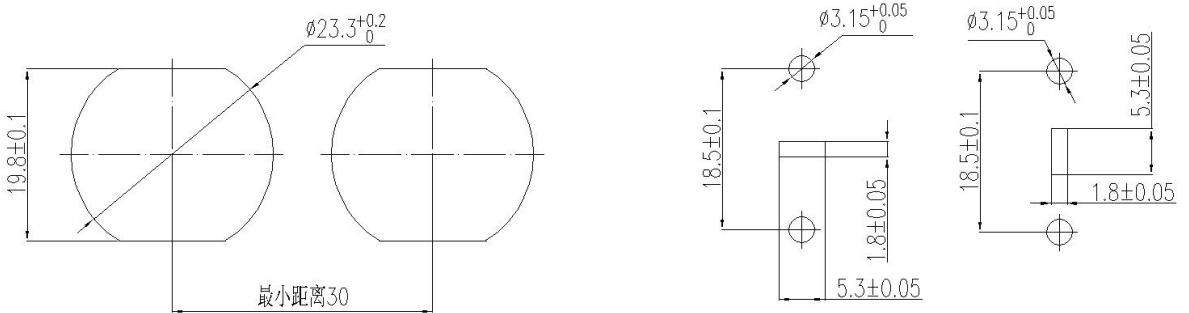

安装面板开孔尺寸

PCB开孔尺寸(正极)

PCB开孔尺寸(负极)



误差补偿范围 Error Compensation Range

对逆变器装配误差补偿范围:

X方向: Max 5mm

Y方向: Max 0.5mm(单边)

Z方向: Max 0.5mm(单边)

Compensation range for inverter assembly error:

X: Max 5mm

Y: Max 0.5mm (bilateral)

Z: Max 0.5mm (bilateral)

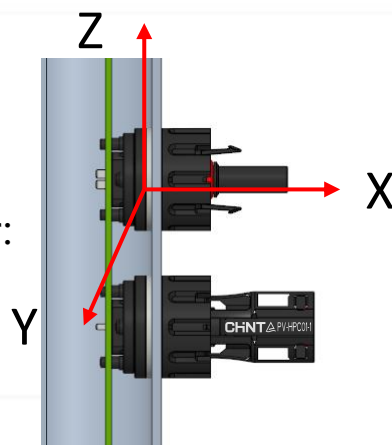

技术参数 Technical Parameters

产品名称/Name:	PV-HPC01x(x=-1)
额定电压/Rated Voltage:	1500V
额定电流/Rated Current:	54A
耐电压/Withstand Voltage:	8000V DC
冲击电压/Rated Impulse Voltage	16kv DC
接触电阻/Contact Resistance:	≤0.4mΩ
绝缘电阻/Insulation resistance:	≥5000MΩ
防护等级/Degree of Protection:	IP65/IP68(1m, 1h)
保护等级/Protection Class:	Class II
温度范围/Temperature Range:	-40°C ~ +85°C
插接寿命/Plug In Lifepan:	≥100次
端子材料/Terminal Material:	T2 镀锡/Sn Plated
外壳材料/ Housing Material:	PA66
阻燃等级/Flame Retardant Rating:	UL94-V0
组装扭矩/Assembly Torque:	3~5N.m
环保要求/Environmental Compliance:	RoHs



产品特性

- 1.连接器内部两段并联连接，温升高，载流量大，更好与柔性PCBA直联。
- 2.电阻焊和压接固线结合，连接更可靠。
- 3.双引线及异形引脚与PCBA直联，焊接接触面大，轻松可靠。
- 4.采用尼龙材料，耐高温（能承受波峰焊的高温）
- 5.占用距离PCBA表面高度 $\leq 3\text{mm}$ 的空间小，使PCBA布局更加灵活。
- 6.编制铜线固定可靠，在高温下不易松脱。
- 7.两段柔性PCBA直联，装配误差补偿更精准，PCBA受装配应力更小。

Product Features

- 1.The connector features two parallel internal conductive segments for low temperature rise, high current carrying capacity, and optimal direct connection with the Flexible PCBA.
2. Combination of resistance welding and crimping offers enhanced connection reliability.
3. Dual leads and customized pins enable direct soldering to the PCBA, ensuring a larger soldering contact area and easy, reliable soldering.
4. Constructed from Nylon material for high temperature resistance (enabling it to withstand the heat of wave soldering).
5. Occupying a small space with a height $\leq 3\text{mm}$ from the PCBA surface, it makes the PCBA layout more flexible.
- 6.The tinned copper conductor is securely crimped, ensuring no loosening even at elevated temperatures
7. The direct connection between the two FPCBA segments allows for more accurate assembly tolerance compensation and reduces mechanical stress on the FPCBA during installation.



操作方法 Operation Method

1. 正极和负极安装到电路板上焊盘孔内，然后对引脚和电路板进行上锡作业（如下图所示）。

Insert the positive and negative connector pins into the PCB solder pad holes, then perform soldering on the pins and the PCB (as shown in the figure below).

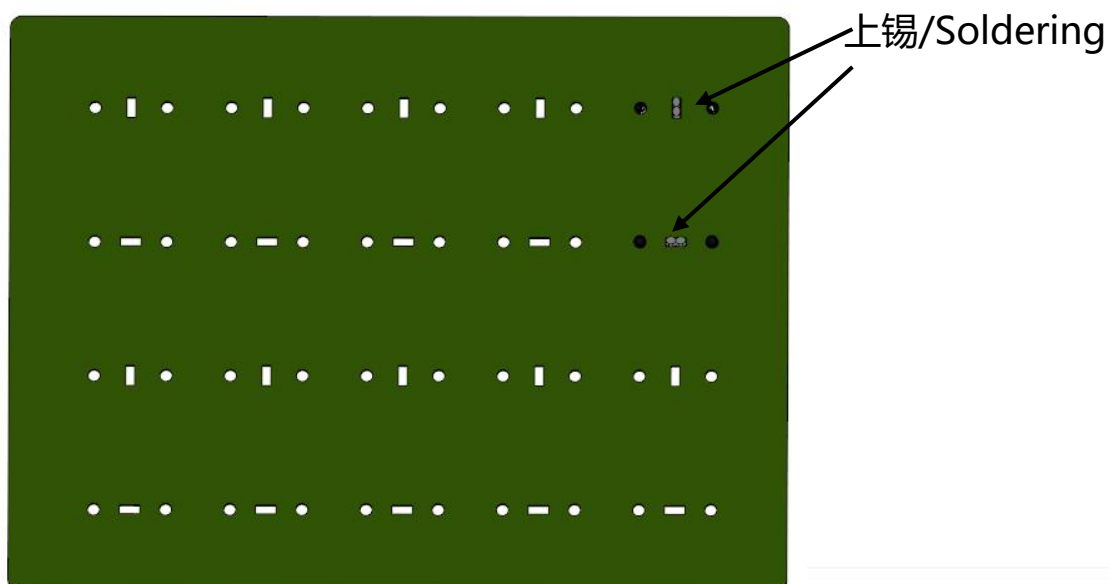
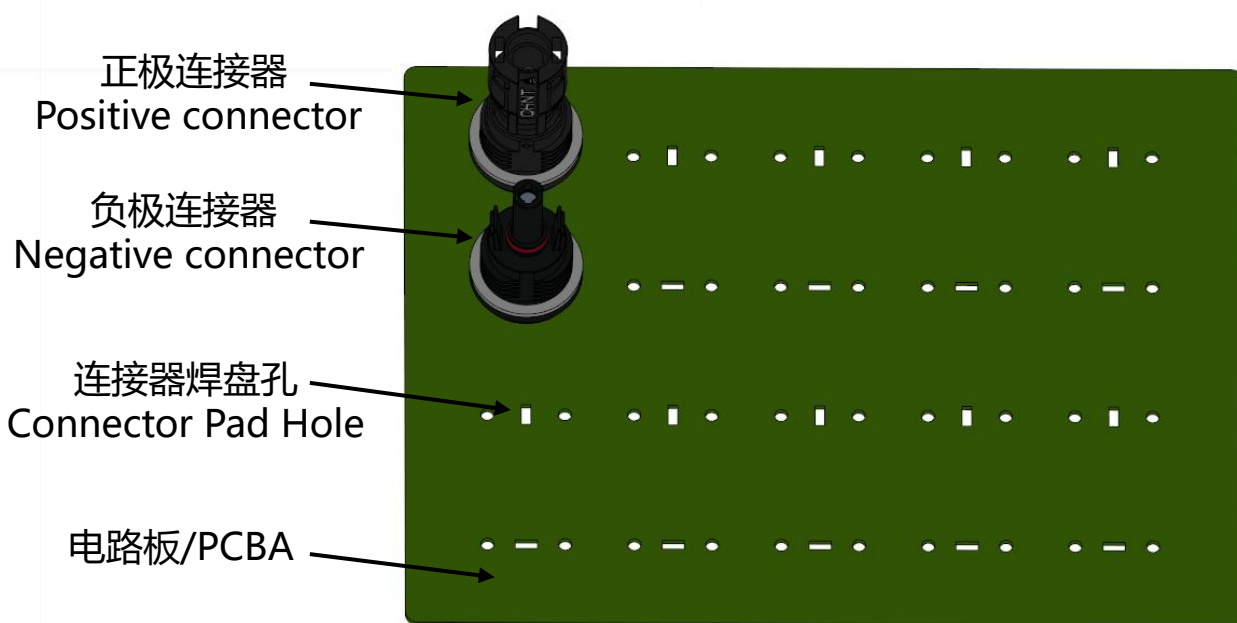



操作方法 Operation Method

2. 将与电路板焊接后的连接器装配到逆变器外壳预留的连接器安装位置上，在逆变器外部拧紧螺帽（如下图所示）。

After soldering, assemble the connector onto the designated mounting position on the inverter housing, and tighten the nut from the outside of the inverter (as shown below)

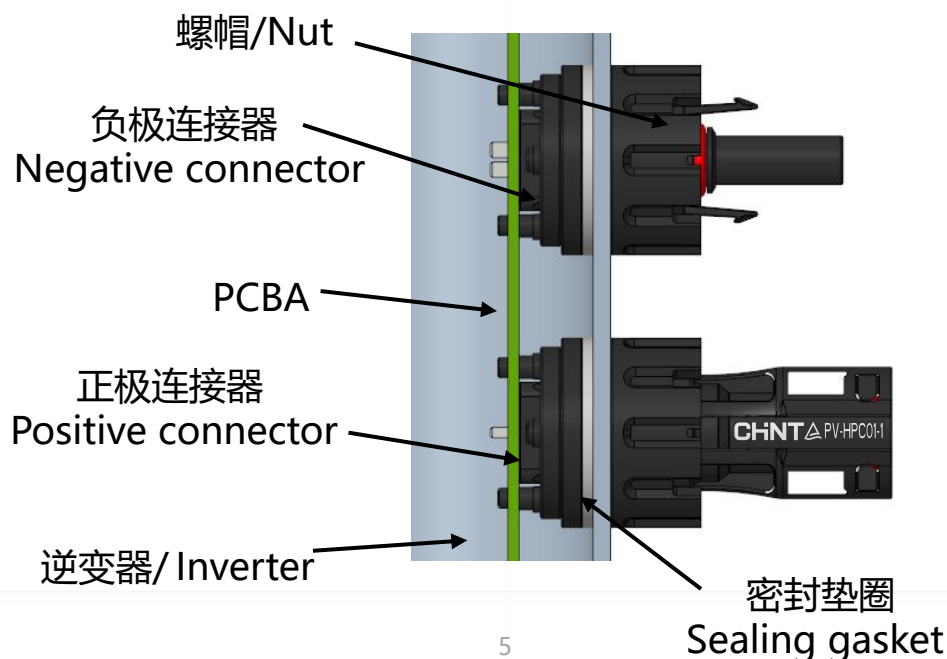
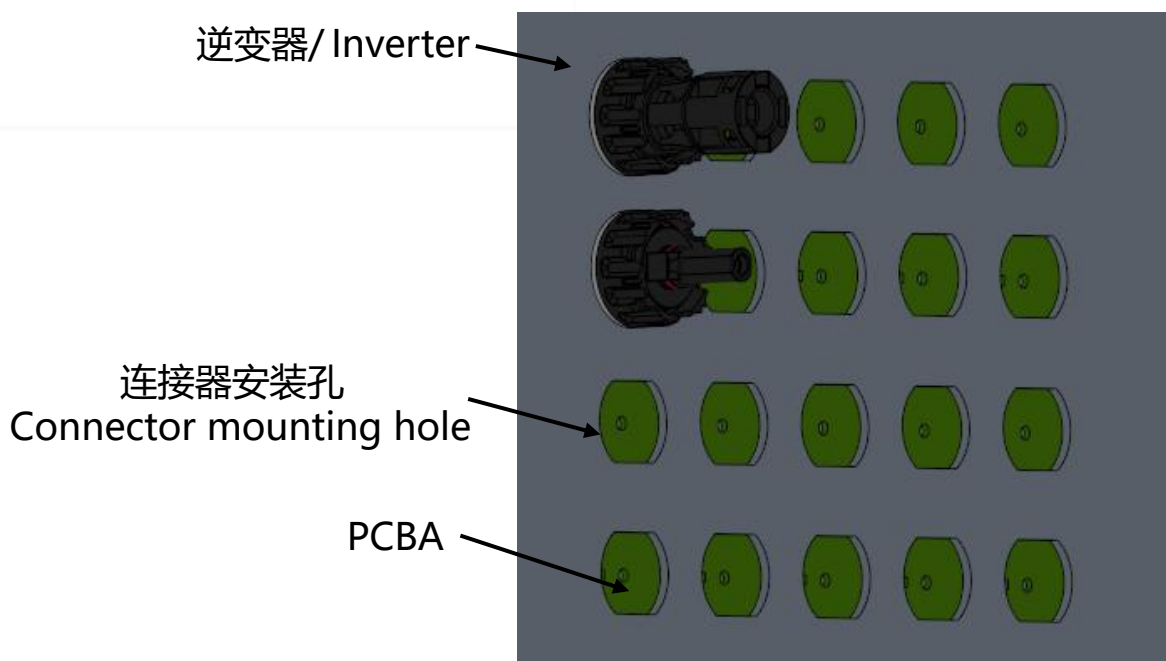



注意事项

1. 板端连接器及与之互配的线端连接器和线缆禁止挂、拉重物。
2. 产品装卸及运输过程中注意轻拿轻放，不要受外力重压，以免造成损坏。
3. 工作人员应配有适当的静电防护措施。
4. 如果不是维护需要，请不要频繁进行连接系统的开合或插拔。
5. 请不要在负载下断开连接。
6. 户外维护应由专业人员进行。
7. 不允许将连接器与市面中其他连接器或规格不匹配的连接进行互插。

Precautions

1. The panel receptacle and its mated cable-side connector and cable must not be subjected to hanging or pulling heavy loads.
2. Handle the product gently during loading, unloading, and transportation, and avoid heavy external pressure to prevent damage.
3. Personnel must be equipped with appropriate Electrostatic Discharge (ESD) protective measures.
4. Do not frequently connect or disconnect the system unless maintenance is required.
5. Never connect or disconnect connectors under load.
6. Outdoor maintenance should be performed by qualified personnel.
7. Do not mate this connector with connectors of other brands or with any connectors that have incompatible specifications.